

# SUPRAFLOW

Under pressure tapping tee for IPS PE pipe

## REFERENCE SPECIFICATIONS

Grid	Gas
Highest operating pressure	150 psi
Pipe material	PE
Pipe outer diameter	4"IPS to 18"IPS
Outlet pipe material	PE
Outlet outer diameter	4"IPS, 6"IPS and 8"IPS



### Applications

Supraflow tapping tees are a unique solution for big flow branching for servicing, grid extension or by-pass installation. A specially designed drill cutter is housed inside Supraflow: it is a minimal shavings cutter retaining both coupon and chips and leaving pipe clean. No other solution offers the possibility to live branching in large diameters (4"IPS, 6"IPS and 8"IPS) in an easy and "intrinsically safe" procedure.

### Advantages

Supraflow tapping tee has sound advantages over any other procedure for tapping:

- Under pressure branching.
- High flow.
- High pressures.
- Intrinsically safe procedure.
- Very fast installation.
- Installation possible in very tight spaces.
- Almost no need for extra excavation.
- Lower public disturbance -> smallest excavation.
- Can be installed in any position.
- No impact on the pipe (no squeezing).
- Externally fully PE covered -> full environment protect.

### Highest operating pressure

Supraflow tapping tee is certified for pressure up to 150 psi.

### Sizes

- Outlets with diameters 4"IPS, 6"IPS and 8"IPS.
- Mains with diameters from 4"IPS to 18"IPS (DR11 and DR13.6).

### Installation

Installation is performed using Supraflow equipment, specially designed and manufactured by Grupo Torre. Supraflow metallic head designed to be attached to the drilling equipment. The whole installation procedure is done under a "zero leaks" environment.

### Standards

Manufacturing, assembly and testing follows strict quality standards and is fully compliant with 49CFR Part 192, having been positively tested under ASTM D2513.

## Technical data

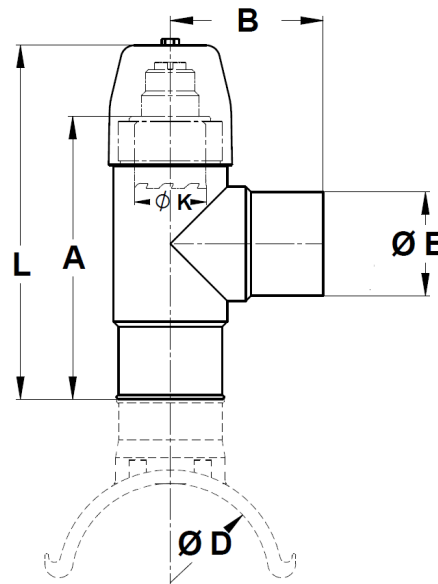

## SUPRAFLOW TAPPING TEES

### SIZES, REFERENCES AND APPLICATION RANGE

REFERENCE	ØD	ØE	A	B	L	ØK	UTS. / BOX
TSP4IPS8	4"IPS	4"IPS	12.32"	6.6"	15.35"	2.44"	2
TSP4IPS9	6"-12"IPS	4"IPS	12.32"	6.6"	15.35"	3.11"	2
TSP6IPS2	6"-18"IPS	6"IPS	14.68"	8.2"	17.59"	4.53"	1
TSP8IPS2	8"-18"IPS	8"IPS	21.26"	12"	24.40"	6.30"	1

NOTE: Saddle not included.

### COMPONENTS

### MATERIALS

TEE	PE3408 / PE4710
BODY	SAE4140 + Bichromated
BODY CAP	SAE1024 + Bichromated
PIN	SAE12L13 + Bichromated
SLEEVE	SAE1024 + Bichromated
CUTTER	SAE4140
O-RINGS	NBR, Rubber (ISO 6447 / 6448)